



# MERLOT

**1841 SQFT** | **3**  **2.5** 

**FEATURES:**

- 9' main floor ceiling
- Side entrance to unfinished basement
- Double garage attached
- Two-tone kitchen cabinets to ceiling
- Quartz countertops
- LVP flooring on main floor
- Open to below great room
- Elevation or exterior layout (shown above) subject to changes to comply with developer guidelines; rendering is not final
- Exterior colours to be selected by builder to comply with developer guidelines
- 24 pocket lot

**NOTES:**

---



---



---



---

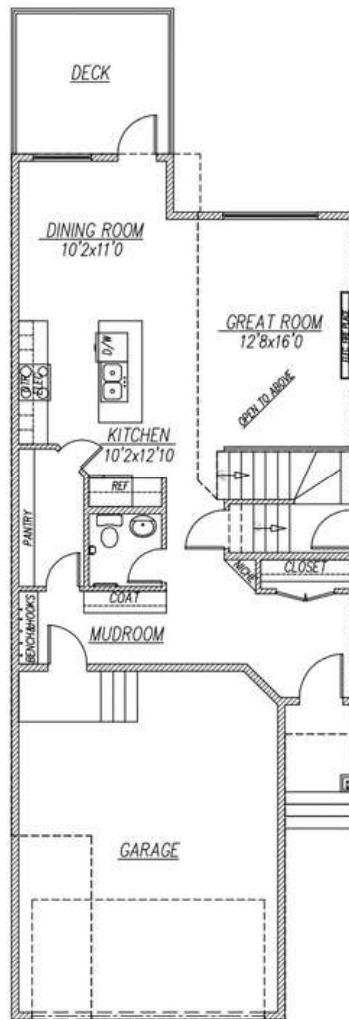

**MAIN - 815 SQFT**

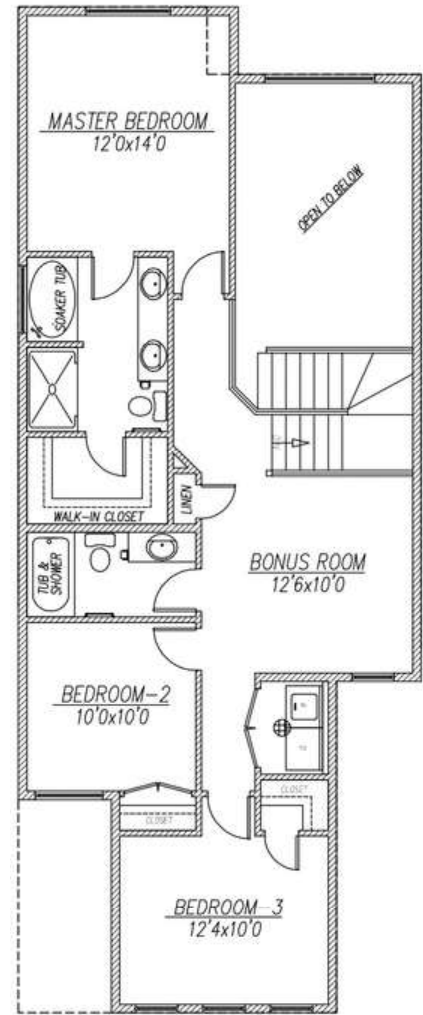

**UPPER - 1026 SQFT**



[www.happyplanethomes.com](http://www.happyplanethomes.com)  
[info@happyplanethomes.com](mailto:info@happyplanethomes.com)  
 8098 Kiriak Link SW, Edmonton, Alberta